

**Standard Features:**

- + Explosion Proof: Class I Groups C & D; Class II Groups F & G (T3B per UL E12044)
- + CSA Certified, under file numbers LR47504 and LR21839
- + No encoder provisions provided
- + Constant torque operation from 0 to base speed
- + Constant Horsepower to twice Base Speed
- + Normally-closed class "F" thermostats (one per phase)
- + 56C-Face with Rigid Base
- + Top mount (F3) conduit box included, shipped loose
- + Marathon Electric provides 3 Year warranty
- + **MT Discount Code**



HP	RPM @ 60Hz	Max CHP RPM	Volts	Frame	Encl	Catalog Number	List Price	Weight (Lbs)	Leadtime (Days)	F.L. Amps
1/4	1725	3540	230/460	56C	TENV	CTY600	\$638	34	5	1.1/0.55
1/3	1725	3520	230/460	56C	TENV	CTY601	\$748	34	20	1.2/0.6
1/2	1735	3510	230/460	56C	TENV	CTY602	\$807	39	5	1.6/0.8
3/4	1755	3500	230/460	56C	TENV	CTY603	\$893	42	20	2.4/1.2
1	1750	3505	230/460	56C	TENV	CTY604	\$978	45	5	3.0/1.5

Prices, Specifications and Availability are subject to change without notice.  
 Contact Control Techniques for other base speeds and options not shown above.

**Dimensions**

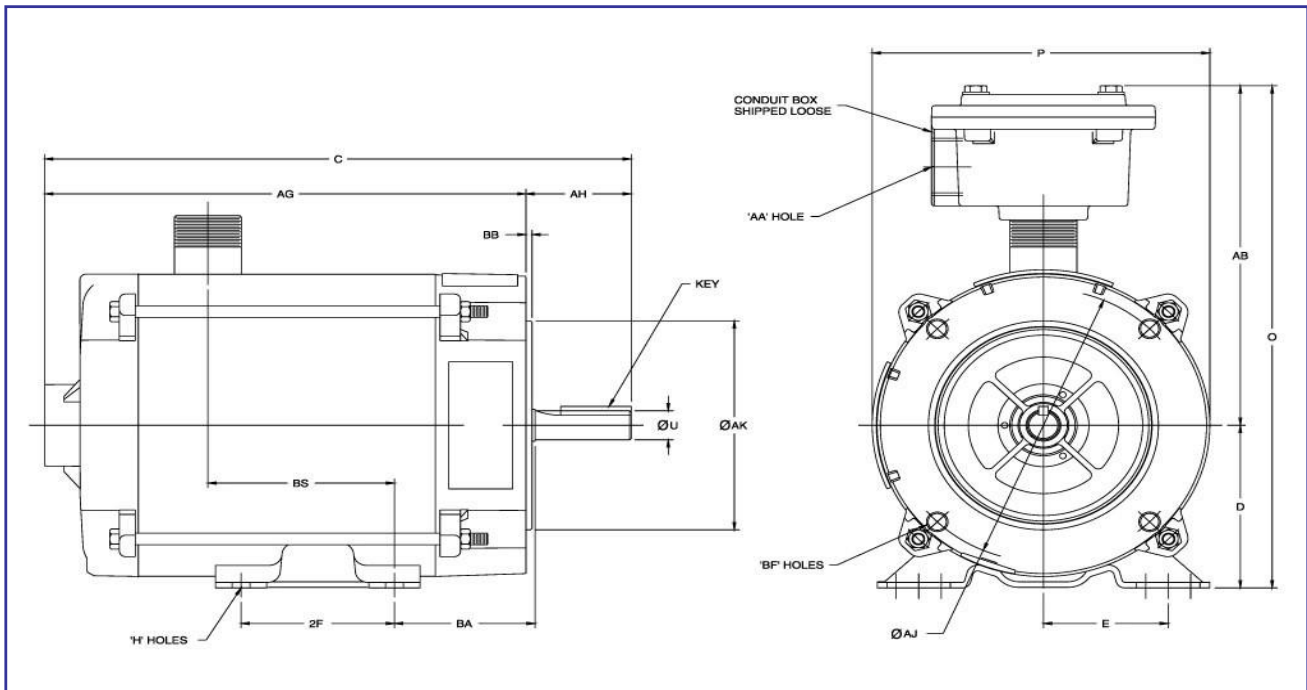

**56C Rolled Steel Construction**

D	E	2F	H	O Max	P Max	U	AA	AB Max	AG Max	AH	AJ	AK	BA	BB	BF	BS	Key
3.50	2.44	3.00	0.34	10.81	6.60	0.625	1.00	7.31	11.91	2.06	5.875	4.500	2.75	0.12	3/8-16	6.15	.19x.19x1.38